

Soils Map

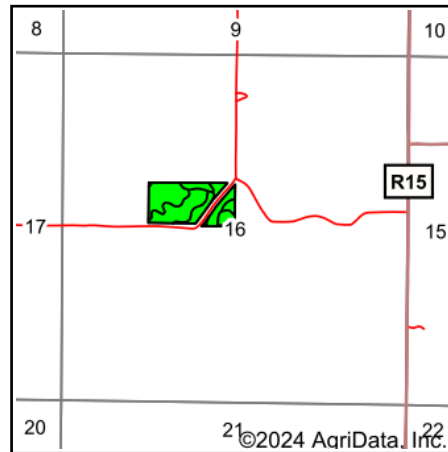

State: **Iowa**
 County: **Clarke**
 Location: **16-73N-27W**
 Township: **Madison**
 Acres: **16.93**
 Date: **5/17/2024**

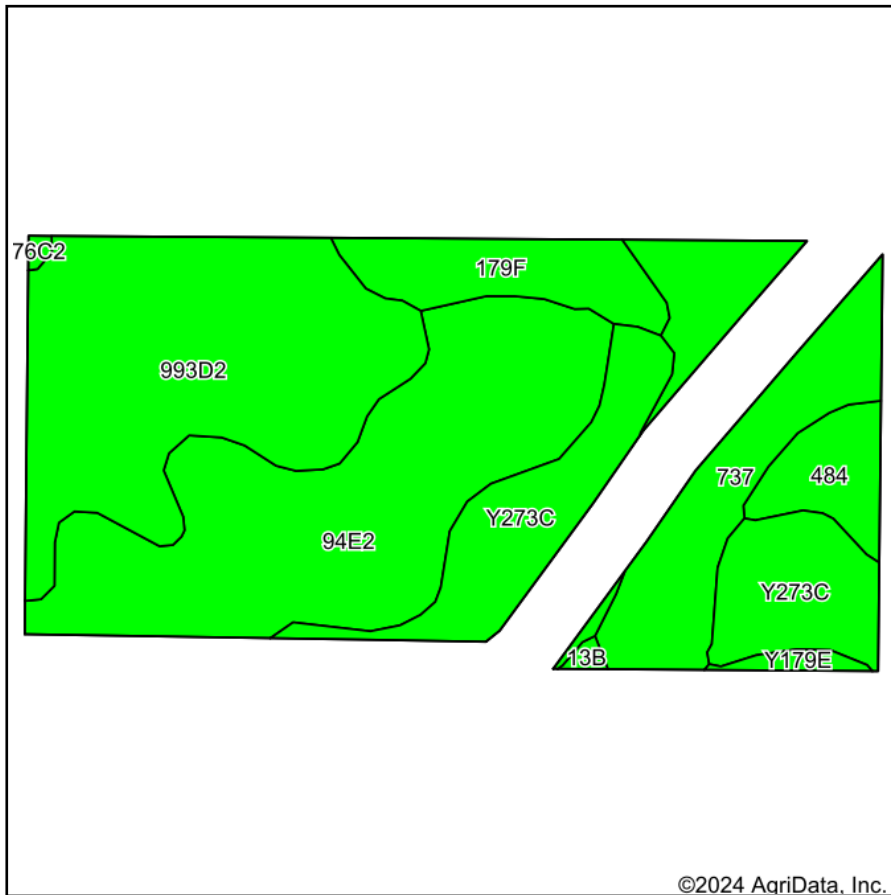

Maps Provided By:



Soils data provided by USDA and NRCS.

Area Symbol: IA039, Soil Area Version: 29

Code	Soil Description	Acres	Percent of field	CSR2 Legend	Non-Irr Class *c	*i Corn Bu	*i Soybeans Bu	CSR2**	CSR	*n NCCPI Overall
94E2	Caleb-Mystic complex, 14 to 18 percent slopes, moderately eroded	5.18	30.5%		Vle	99.2	28.8	23	5	68
993D2	Gara-Armstrong clay loams, 9 to 14 percent slopes, moderately eroded	4.77	28.2%		IVe	123.2	35.7	30	20	67
Y273C	Olmitz loam, 5 to 9 percent slopes	2.69	15.9%		IIIe	0.0	0.0	85		96
737	Nodaway-Lawson silt loams, 0 to 2 percent slopes, occasionally flooded	2.43	14.4%		IIw			80		93
179F	Gara loam, 18 to 25 percent slopes	1.07	6.3%		Vle	120.0	34.8	18	10	61
484	Lawson silt loam, 0 to 2 percent slopes	0.66	3.9%		IIw	219.2	63.6	83	90	88
Y179E	Gara loam, dissected till plain, 14 to 18 percent slopes	0.13	0.8%		Vle			37		78
Weighted Average					4.23	81.2	23.5	45.1	*-	*n 76.2

**IA has updated the CSR values for each county to CSR2.

*- CSR weighted average cannot be calculated on the current soils data, use prior data version for csr values.*i Yield data provided by the ISPAID Database version 8.1.1 developed by IA State University.

*n: The aggregation method is "Weighted Average using all components"

*c: Using Capabilities Class Dominant Condition Aggregation Method