

Soils Map

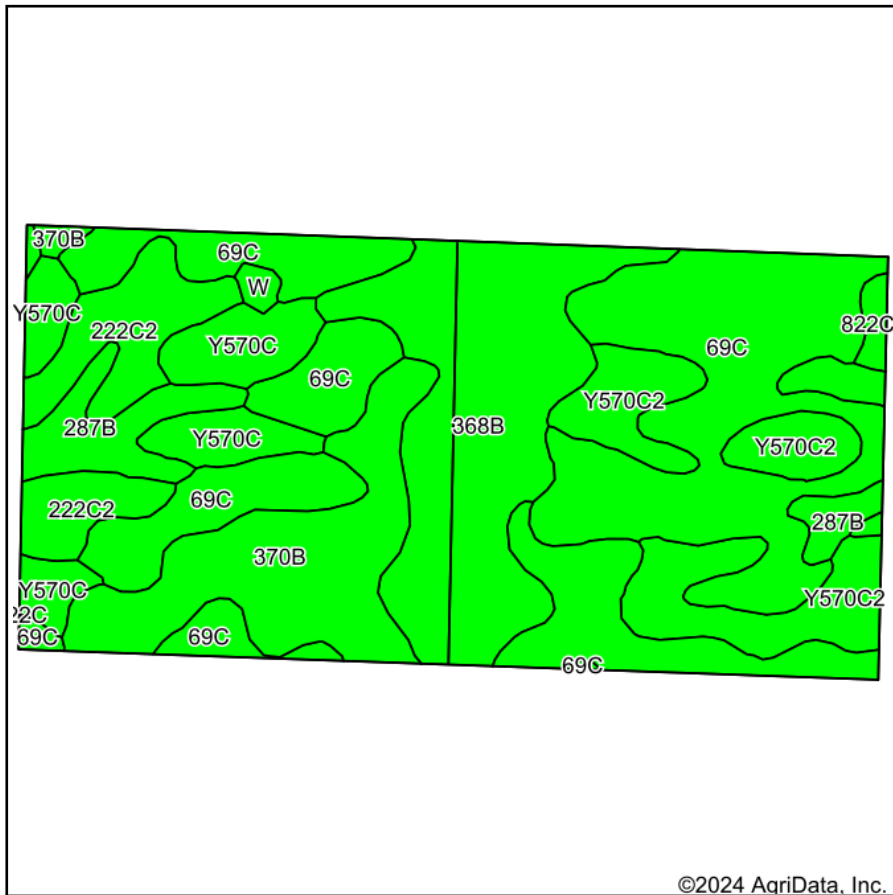

Soils data provided by USDA and NRCS.

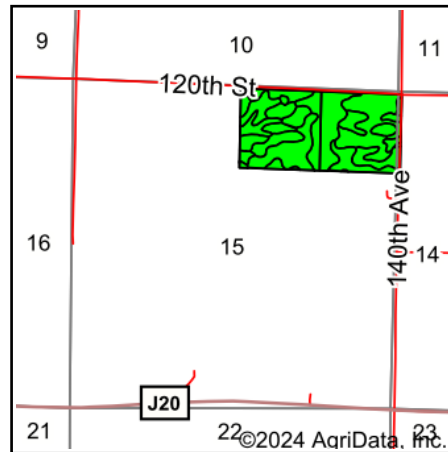

State: **Iowa**
 County: **Ringgold**
 Location: **15-70N-31W**
 Township: **Lincoln**
 Acres: **80.06**
 Date: **1/19/2024**



Maps Provided By:



© AgriData, Inc. 2023

www.AgriDataInc.com



Area Symbol: IA159, Soil Area Version: 29

Code	Soil Description	Acres	Percent of field	CSR2 Legend	Non-Irr Class *c	*j Corn Bu	*j Soybeans Bu	CSR2**	CSR	*n NCCPI Overall
69C	Clearfield silty clay loam, dissected till plain, 5 to 9 percent slopes	25.79	32.2%		IIIw	168.0	48.7	59	50	76
368B	Macksburg silty clay loam, 2 to 5 percent slopes	14.79	18.5%		IIe	222.4	64.5	89	90	87
370B	Sharpsburg silty clay loam, 2 to 5 percent slopes	14.31	17.9%		IIe	225.6	65.4	91	87	92
Y570C2	Nira silty clay loam, dissected till plain, 5 to 9 percent slopes, eroded	8.26	10.3%		IIIe			81		84
Y570C	Nira silty clay loam, dissected till plain, 5 to 9 percent slopes	5.77	7.2%		IIIe			84		90
222C2	Clarinda silty clay loam, 5 to 9 percent slopes, moderately eroded	5.72	7.1%		IVw	140.8	40.8	28	25	54
287B	Zook-Ely silty clay loams, 0 to 5 percent slopes	4.46	5.6%		IIw	184.0	53.4	75	60	72
822C2	Lamoni silty clay loam, 5 to 9 percent slopes, moderately eroded	0.51	0.6%		IIIe	129.6	37.6	31	30	61
W	Water	0.34	0.4%			0.0	0.0	0	0	
822D2	Lamoni silty clay loam, 9 to 14 percent slopes, moderately eroded	0.11	0.1%		IVe	100.8	29.2	10	15	63
Weighted Average						*- 156.8	45.5	72.5	*-	*n 80.5

Soils data provided by USDA and NRCS.

**IA has updated the CSR values for each county to CSR2.

**IA has updated the CSR values for each county to CSR2.*- CSR weighted average cannot be calculated on the current soils data, use prior data version for csr values.

**IA has updated the CSR values for each county to CSR2.*- CSR weighted average cannot be calculated on the current soils data, use prior data version for csr values.*i Yield data provided by the ISPAID Database version 8.1.1 developed by IA State University.

*n: The aggregation method is "Weighted Average using all components"

**IA has updated the CSR values for each county to CSR2.*- CSR weighted average cannot be calculated on the current soils data, use prior data version for csr values.*i Yield data provided by the ISPAID Database version 8.1.1 developed by IA State University.*c: Using Capabilities Class Dominant Condition Aggregation Method

**IA has updated the CSR values for each county to CSR2.*- CSR weighted average cannot be calculated on the current soils data, use prior data version for csr values.*i Yield data provided by the ISPAID Database version 8.1.1 developed by IA State University.*c: Using Capabilities Class Dominant Condition Aggregation Method*- Non Irr Class weighted average cannot be calculated on the current soils data due to missing data.