

Soils Map

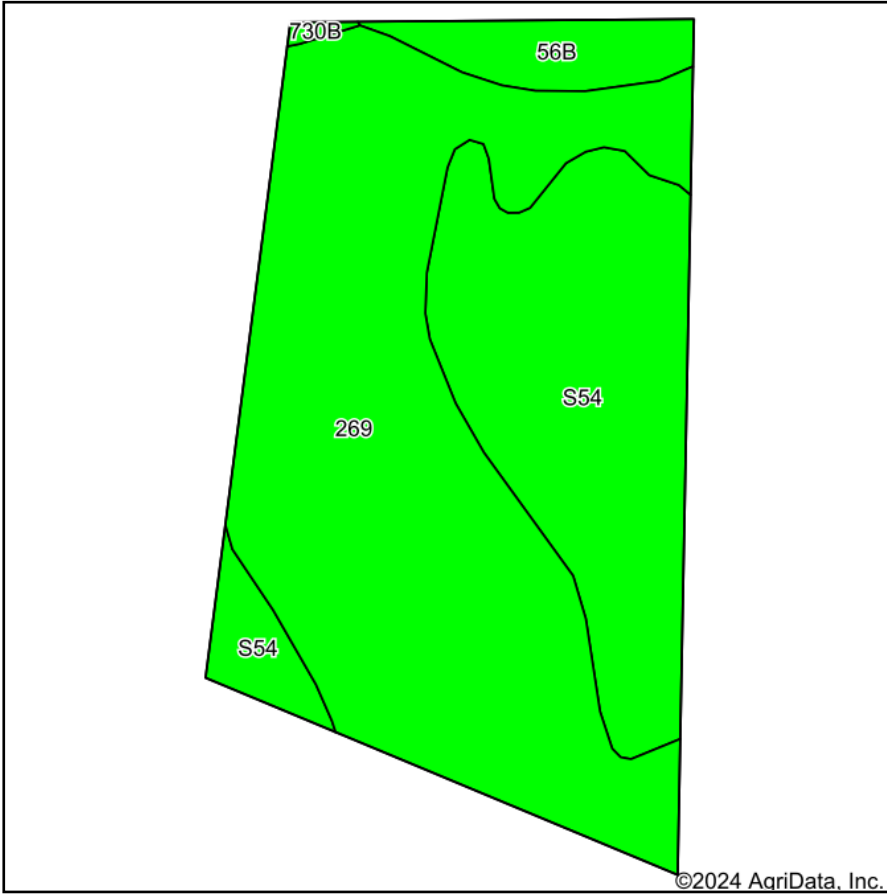

Soils data provided by USDA and NRCS.

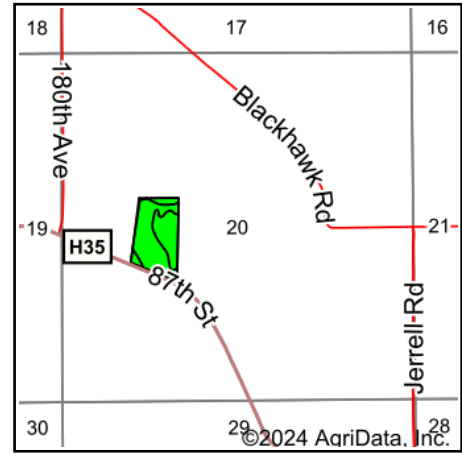

State: **Iowa**
 County: **Wapello**
 Location: **20-72N-14W**
 Township: **Center**
 Acres: **17**
 Date: **1/11/2024**



Maps Provided By:



Area Symbol: IA179, Soil Area Version: 32

Code	Soil Description	Acres	Percent of field	CSR2 Legend	Non-Irr Class *c	*i Corn Bu	*i Soybeans Bu	CSR2**	CSR	*n NCCPI Overall
269	Humeston silt loam, 0 to 2 percent slopes, occasionally flooded	10.29	60.5%		Illw	80.0	23.2	70	58	90
S54	Zook silty clay loam, heavy till, 0 to 2 percent slopes, occasionally flooded	5.82	34.2%		Ilw	0.0	0.0	68		74
56B	Cantril loam, 2 to 5 percent slopes	0.89	5.2%		Ile	209.6	60.8	79	65	86
Weighted Average						2.61	59.4	17.2	69.8	*n 84.3

**IA has updated the CSR values for each county to CSR2.

**IA has updated the CSR values for each county to CSR2.*- CSR weighted average cannot be calculated on the current soils data, use prior data version for csr values.

**IA has updated the CSR values for each county to CSR2.*- CSR weighted average cannot be calculated on the current soils data, use prior data version for csr values.*i Yield data provided by the ISPAID Database version 8.1.1 developed by IA State University.

*n: The aggregation method is "Weighted Average using all components"

**IA has updated the CSR values for each county to CSR2.*- CSR weighted average cannot be calculated on the current soils data, use prior data version for csr values.*i Yield data provided by the ISPAID Database version 8.1.1 developed by IA State University.*c: Using Capabilities Class Dominant Condition Aggregation Method