

Soils Map

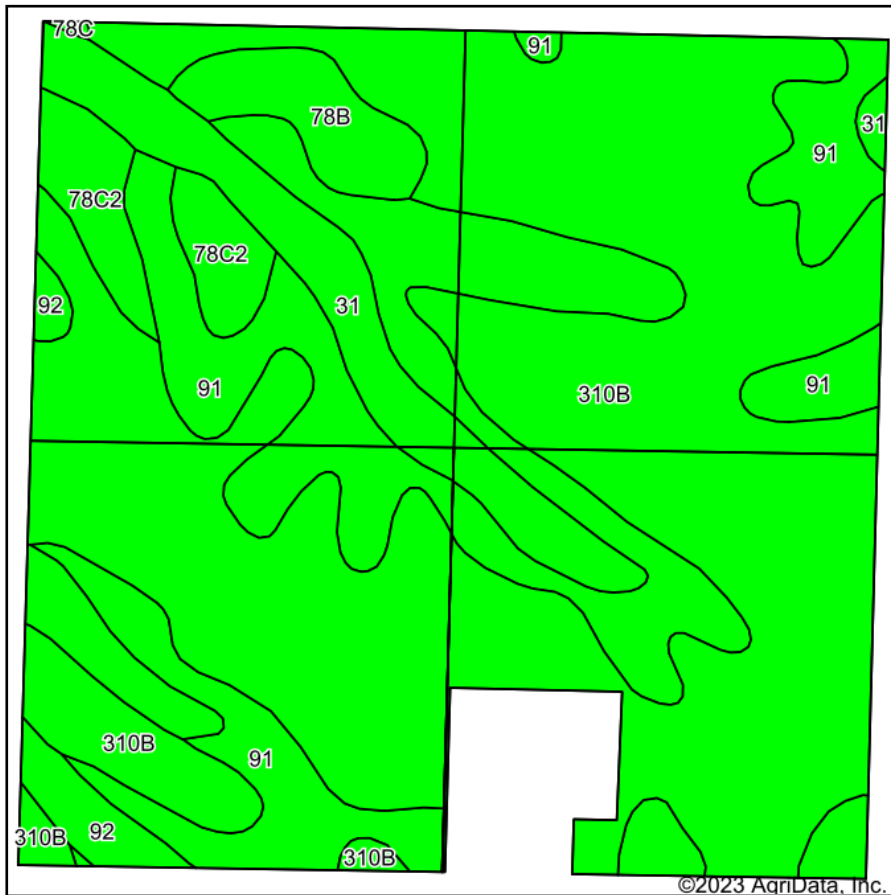

Soils data provided by USDA and NRCS.

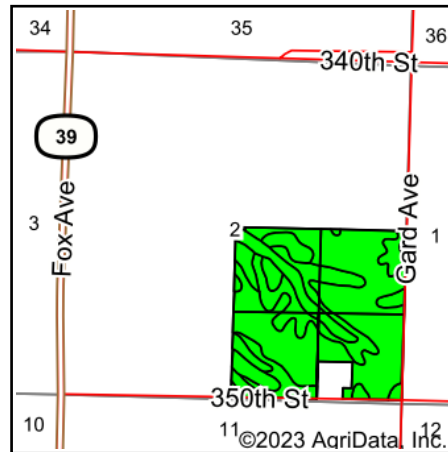

State: **Iowa**
 County: **Sac**
 Location: **2-86N-38W**
 Township: **Wheeler**
 Acres: **151.88**
 Date: **11/2/2023**



Maps Provided By:



Area Symbol: IA161, Soil Area Version: 31

Code	Soil Description	Acres	Percent of field	CSR2 Legend	Non-Irr Class *c	*i Corn Bu	*i Soybeans Bu	CSR2**	CSR	*n NCCPI Overall	
310B	Galva silty clay loam, 2 to 5 percent slopes	88.18	58.1%		Ile	232.0	67.3	95	75	75	
91	Primghar silty clay loam, 0 to 2 percent slopes	38.42	25.3%		Iw	240.0	69.6	100	84	78	
31	Afton silty clay loam, 0 to 2 percent slopes, occasionally flooded	10.14	6.7%		Ilw	204.8	59.4	80	77	68	
78C2	Sac silty clay loam, 5 to 9 percent slopes, eroded	5.49	3.6%		Ille	211.2	61.2	82	54	70	
92	Marcus silty clay loam, 0 to 2 percent slopes	5.15	3.4%		Ilw	230.4	66.8	94	80	75	
78B	Sac silty clay loam, 2 to 5 percent slopes	4.41	2.9%		Ile	232.0	67.3	89	71	73	
78C	Sac silty clay loam, 5 to 9 percent slopes	0.09	0.1%		Ille	216.0	62.6	84	56	72	
Weighted Average						1.78	231.4	67.1	94.6	76.7	*n 75.1

**IA has updated the CSR values for each county to CSR2.

*i Yield data provided by the ISPAID Database version 8.1.1 developed by IA State University.

*n: The aggregation method is "Weighted Average using all components"

*c: Using Capabilities Class Dominant Condition Aggregation Method

Soils data provided by USDA and NRCS.