

Soils Map

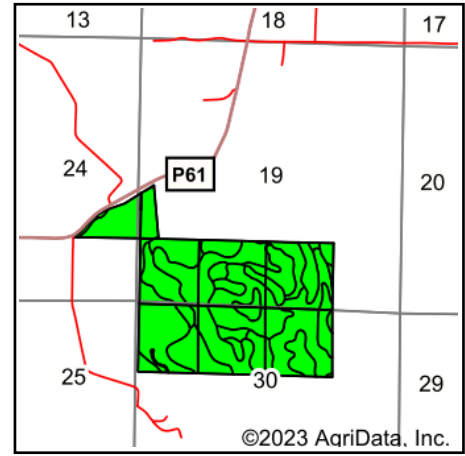

State: **Iowa**
 County: **Union**
 Location: **19-73N-28W**
 Township: **New Hope**
 Acres: **250.98**
 Date: **3/29/2023**

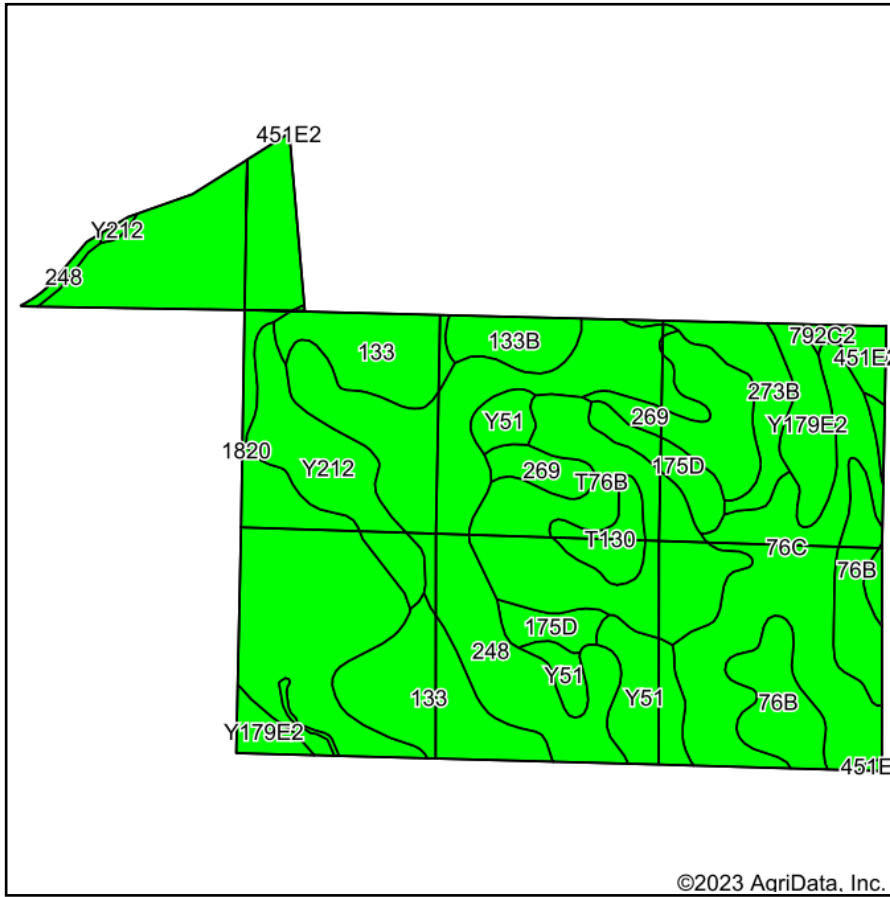

Maps Provided By:



Soils data provided by USDA and NRCS.

©2023 AgriData, Inc.

Area Symbol: IA175, Soil Area Version: 25

Code	Soil Description	Acres	Percent of field	CSR2 Legend	Non-Irr Class *c	*i Corn Bu	*j Soybeans Bu	CSR2**	CS R	*n NCCPI Overall	
1820	Dockery-Quiver silt loams, 0 to 2 percent slopes, occasionally flooded	48.73	19.4%		Ilw			87		93	
248	Wabash silty clay loam, 0 to 2 percent slopes	39.72	15.8%		Illw	177.6	51.5	41	60	55	
76C	Ladoga silt loam, dissected till plain, 5 to 9 percent slopes	29.89	11.9%		Ille	196.8	57.1	80	67	79	
T76B	Ladoga silt loam, terrace on dissected till plain, 2 to 5 percent slopes	25.54	10.2%		Ile	212.8	61.7	86	82	82	
133	Colo silty clay loam, deep loess, 0 to 2 percent slopes, occasionally flooded	22.94	9.1%		Ilw	204.8	59.4	78	80	81	
76B	Ladoga silt loam, 2 to 5 percent slopes	13.18	5.3%		Ile	212.8	61.7	86	82	82	
Y212	Kennebec silt loam, 0 to 2 percent slopes, occasionally flooded	12.32	4.9%		Iw	0.0	0.0	91		95	
269	Humeston silty clay loam, 0 to 2 percent slopes	12.16	4.8%		Illw	80.0	23.2	75	58	75	
Y51	Vesser silt loam, dissected till plain, 0 to 2 percent slopes, occasionally flooded	11.59	4.6%		Ilw			74		88	
Y179E2	Gara loam, dissected till plain, 14 to 18 percent slopes, eroded	8.42	3.4%		Vle			32		69	
175D	Dickinson fine sandy loam, 5 to 14 percent slopes	7.02	2.8%		IVe	80.0	23.2	29	13	61	
273B	Olmitz loam, 2 to 5 percent slopes	6.71	2.7%		Ile	224.0	65.0	89	72	96	
133B	Colo silty clay loam, dissected till plain, 2 to 5 percent slopes, occasionally flooded	4.94	2.0%		Ilw	196.8	57.1	74	75	83	
T130	Belinda silt loam, terrace, 0 to 2 percent slopes	4.03	1.6%		Illw	201.6	58.5	48	60	80	
451E2	Caleb loam, 14 to 18 percent slopes, moderately eroded	2.30	0.9%		Vle	139.2	40.4	36	23	75	
792D2	Armstrong loam, 9 to 14 percent slopes, moderately eroded	0.57	0.2%		IVe	88.0	25.5	7	13	67	
792C2	Armstrong loam, 5 to 9 percent slopes, moderately eroded	0.55	0.2%		Ille	123.2	35.7	26	27	70	
W	Water	0.37	0.1%			0.0	0.0	0	0		
Weighted Average						*-	124.1	36	71.7	*-	*n 79.1

**IA has updated the CSR values for each county to CSR2.

*- CSR weighted average cannot be calculated on the current soils data, use prior data version for csr values.

*i Yield data provided by the ISPAID Database version 8.1.1 developed by IA State University.

*n: The aggregation method is "Weighted Average using all components"

*c: Using Capabilities Class Dominant Condition Aggregation Method

*- Non Irr Class weighted average cannot be calculated on the current soils data due to missing data.

Soils data provided by USDA and NRCS.