

Soils Map

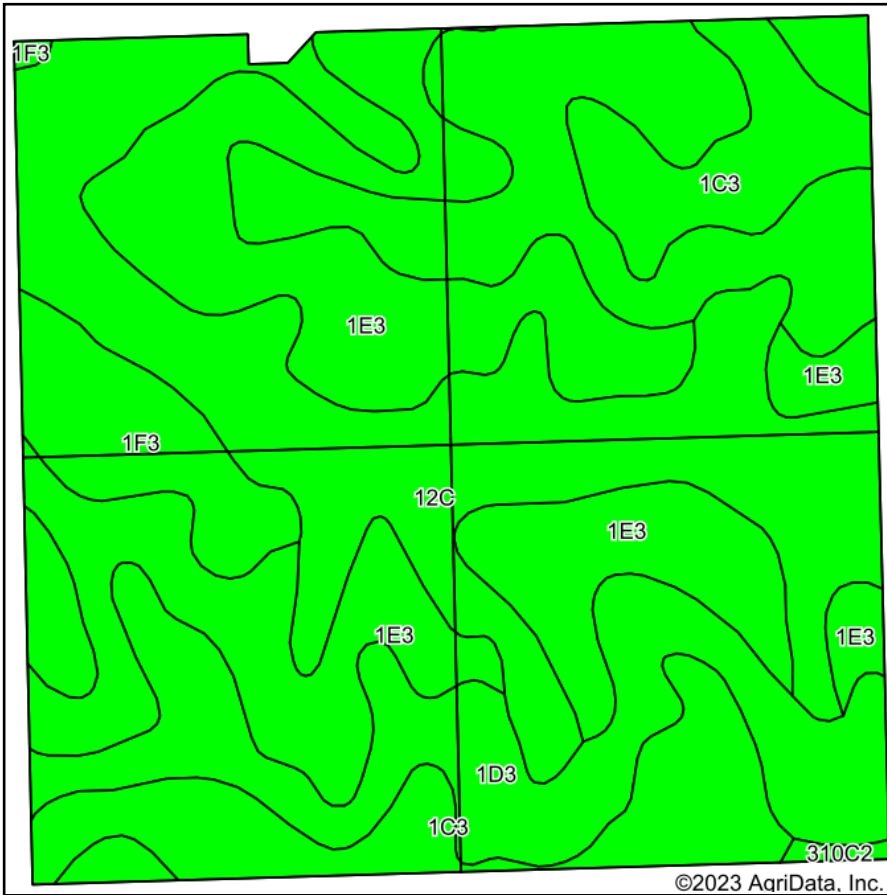

Soils data provided by USDA and NRCS.

©2023 AgriData, Inc.

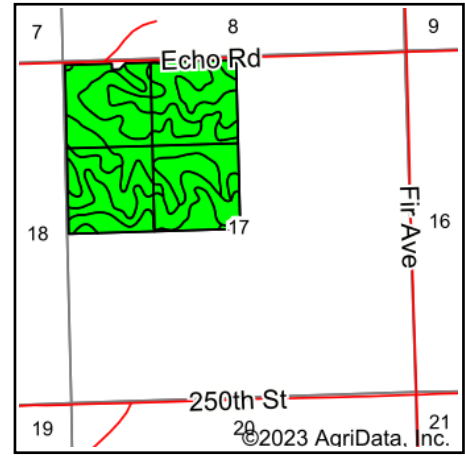

State: **Iowa**
 County: **Plymouth**
 Location: **17-91N-47W**
 Township: **Liberty**
 Acres: **156.71**
 Date: **3/7/2023**



Maps Provided By:



Area Symbol: IA149, Soil Area Version: 33

Code	Soil Description	Acres	Percent of field	CSR2 Legend	Non-Irr Class *c	*i Corn Bu	*i Soybeans Bu	CSR2**	CS R	*n NCCPI Overall
1E3	Ida silt loam, 14 to 20 percent slopes, severely eroded	46.49	29.7%		IVe	97.6	28.3	18	26	57
1D3	Ida silt loam, 9 to 14 percent slopes, severely eroded	42.26	27.0%		IIIe	126.4	36.7	32	35	60
12C	Napier silt loam, 5 to 9 percent slopes	38.36	24.5%		IIIe	214.4	62.2	89	55	87
1C3	Ida silt loam, 5 to 9 percent slopes, severely eroded	19.57	12.5%		IIIe	155.2	45.0	58	44	63
1F3	Ida silt loam, 20 to 30 percent slopes, severely eroded	9.64	6.2%		VIe	88.0	25.5	8	9	17
310C2	Galva silty clay loam, 5 to 9 percent slopes, eroded	0.39	0.2%		IIIe	211.2	61.2	84	51	67
Weighted Average					3.48	140.8	40.9	43.7	36.8	*n 63.5

**IA has updated the CSR values for each county to CSR2.

*i Yield data provided by the ISPAID Database version 8.1.1 developed by IA State University.

*n: The aggregation method is "Weighted Average using all components"

*c: Using Capabilities Class Dominant Condition Aggregation Method

Soils data provided by USDA and NRCS.