

Soils Map

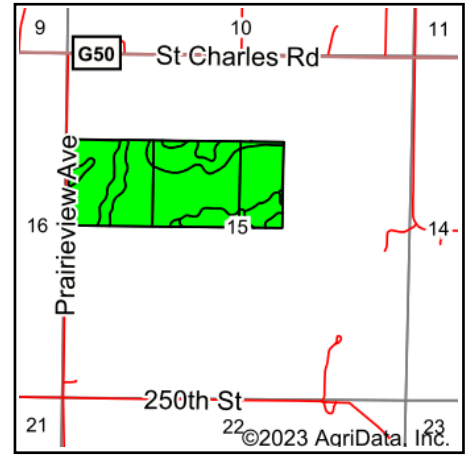

State: **Iowa**
 County: **Madison**
 Location: **15-75N-27W**
 Township: **Scott**
 Acres: **98.55**
 Date: **1/11/2023**

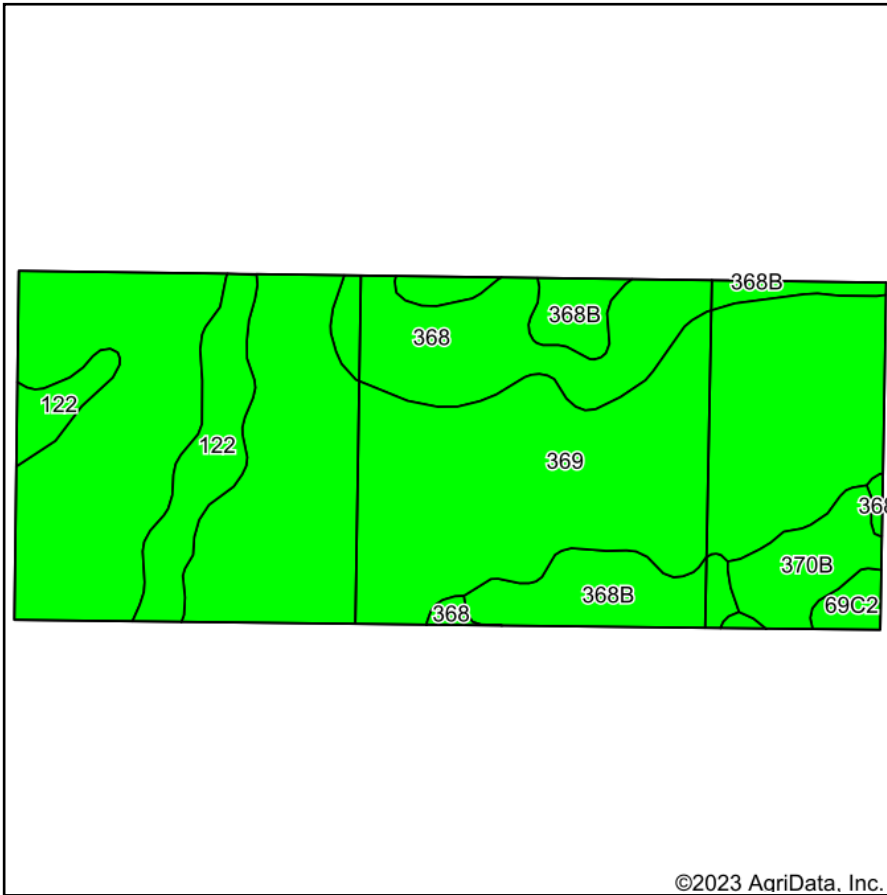

Maps Provided By



Soils data provided by USDA and NRCS.

Area Symbol: IA121, Soil Area Version: 26								
Code	Soil Description	Acres	Percent of field	CSR2 Legend	Non-Irr Class *c	CSR2**	*n NCCPI Overall	
369	Winterset silty clay loam, 0 to 2 percent slopes	66.77	67.8%		IIw	83	78	
368	Macksburg silty clay loam, 0 to 2 percent slopes	11.92	12.1%		Iw	93	87	
368B	Macksburg silty clay loam, 2 to 5 percent slopes	7.84	8.0%		Ile	89	87	
122	Sperry silt loam	6.92	7.0%		IIIw	33	85	
370B	Sharpsburg silty clay loam, 2 to 5 percent slopes	3.91	4.0%		Ile	91	92	
69C2	Clearfield silty clay loam, dissected till plain, 5 to 9 percent slopes, eroded	1.19	1.2%		IIIw	56	66	
Weighted Average						1.96	81.2	*n 80.7

**IA has updated the CSR values for each county to CSR2.

*n: The aggregation method is "Weighted Average using all components"

*c: Using Capabilities Class Dominant Condition Aggregation Method

Soils data provided by USDA and NRCS.