

Soils Map

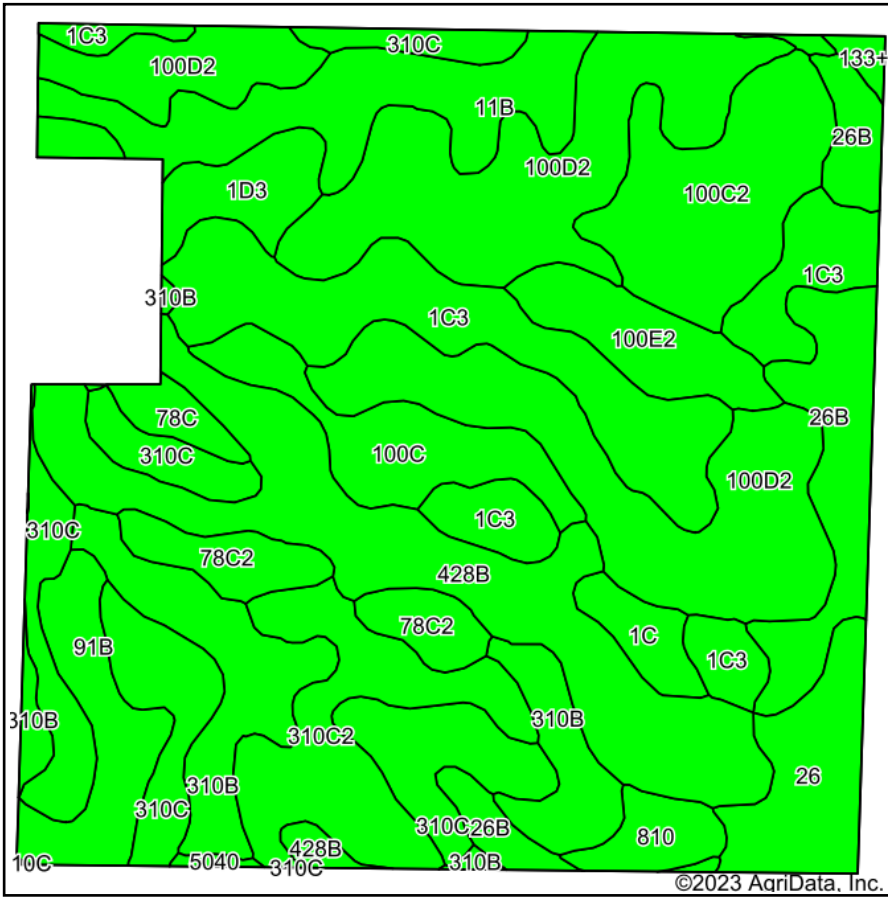

Soils data provided by USDA and NRCS.

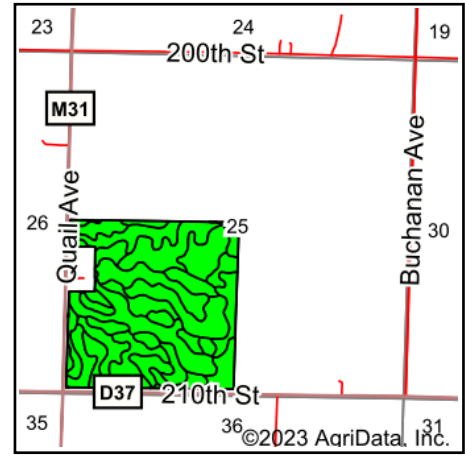

State: **Iowa**
 County: **Ida**
 Location: **25-88N-39W**
 Township: **Silver Creek**
 Acres: **146.92**
 Date: **1/30/2023**



Maps Provided By



Area Symbol: IA093, Soil Area Version: 33

Code	Soil Description	Acres	Percent of field	CSR2 Legend	Non-Irr Class *c	*i Corn Bu	*i Soybeans Bu	CSR2**	CS R	*n NCCPI Overall	
100D2	Monona silty clay loam, 9 to 14 percent slopes, eroded	28.29	19.3%		IIIe	177.6	51.5	60	47	72	
1C3	Ida silt loam, 5 to 9 percent slopes, severely eroded	16.81	11.4%		IIIe	155.2	45.0	58	46	63	
428B	Ely silty clay loam, shallow loess, 2 to 5 percent slopes	15.94	10.8%		Ile	220.8	64.0	88	78	90	
310C	Galva silty clay loam, 5 to 9 percent slopes	12.91	8.8%		IIIe	216.0	62.6	87	57	77	
310B	Galva silty clay loam, 2 to 5 percent slopes	9.51	6.5%		Ile	232.0	67.3	95	73	75	
100C2	Monona silty clay loam, 5 to 9 percent slopes, eroded	8.54	5.8%		IIIe	211.2	61.2	85	56	75	
26B	Kennebec silty clay loam, 2 to 5 percent slopes, occasionally flooded	8.43	5.7%		Ile	220.8	64.0	88	73	92	
11B	Colo-Judson silty clay loams, 0 to 5 percent slopes, occasionally flooded	8.18	5.6%		IIlw	216.0	62.6	80	62	87	
310C2	Galva silty clay loam, 5 to 9 percent slopes, eroded	7.91	5.4%		IIIe	211.2	61.2	84	55	67	
100C	Monona silty clay loam, 5 to 9 percent slopes	5.10	3.5%		IIIe	216.0	62.6	90	58	84	
26	Kennebec silty clay loam, 0 to 2 percent slopes, occasionally flooded	4.89	3.3%		Iw	228.8	66.4	92	78	92	
91B	Primghar silty clay loam, 2 to 5 percent slopes	4.62	3.1%		Ile	232.0	67.3	95	81	78	
100E2	Monona silty clay loam, 14 to 20 percent slopes, eroded	3.90	2.7%		IVe	153.6	44.5	46	38	67	
78C2	Sac silty clay loam, 5 to 9 percent slopes, eroded	3.76	2.6%		IIIe	211.2	61.2	82	51	70	
1D3	Ida silt loam, 9 to 14 percent slopes, severely eroded	2.75	1.9%		IIIe	126.4	36.7	32	37	60	
810	Galva silty clay loam, terrace, 0 to 2 percent slopes	1.82	1.2%		I	240.0	69.6	100	78	77	
1C	Ida silt loam, 5 to 9 percent slopes	1.70	1.2%		IIIe	169.6	49.2	65	51	81	
78C	Sac silty clay loam, 5 to 9 percent slopes	1.21	0.8%		IIIe	216.0	62.6	84	53	73	
133+	Colo silt loam, deep loess, 0 to 2 percent slopes, overwash, occasionally flooded	0.45	0.3%		IIlw	204.8	59.4	78	80	85	
5040	Udorthents, loamy	0.20	0.1%			88.0	25.5	5	5		
Weighted Average						*-	200	58	76.5	58.8	*n 76.4

**IA has updated the CSR values for each county to CSR2.

*i Yield data provided by the ISPAID Database version 8.1.1 developed by IA State University.

*n: The aggregation method is "Weighted Average using all components"

*c: Using Capabilities Class Dominant Condition Aggregation Method

*- Non Irr Class weighted average cannot be calculated on the current soils data due to missing data.

Soils data provided by USDA and NRCS.