

# Soils Map

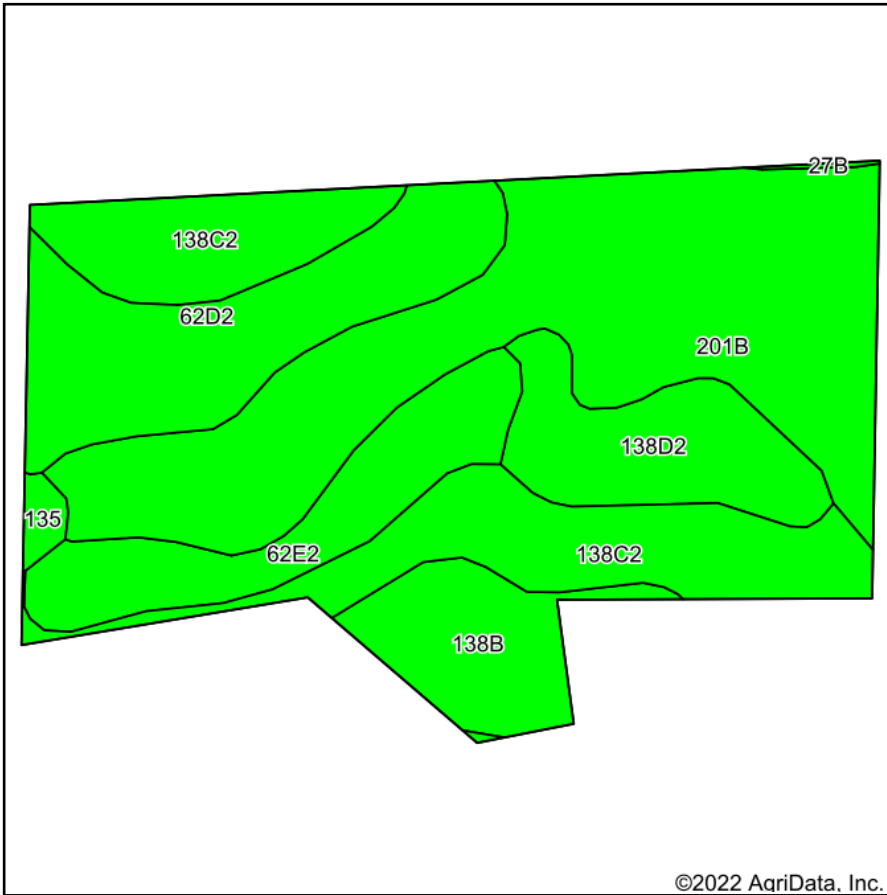

©2022 AgriData, Inc.

Soils data provided by USDA and NRCS.

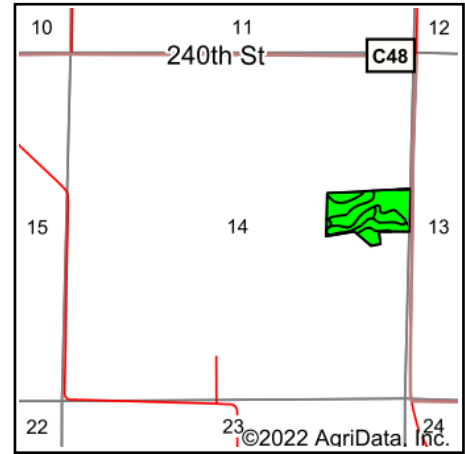

State: **Iowa**  
 County: **Wright**  
 Location: **14-91N-23W**  
 Township: **Blaine**  
 Acres: **19.86**  
 Date: **10/18/2022**



Maps Provided By



© AgriData, Inc. 2021

www.AgriDataInc.com



Area Symbol: IA197, Soil Area Version: 30

Code	Soil Description	Acres	Percent of field	CSR2 Legend	Non-Irr Class *c	*i Corn Bu	*i Soybeans Bu	CSR2**	CS R	*n NCCPI Overall	
201B	Coland-Terril complex, 1 to 5 percent slopes	7.23	36.4%		Ile	208.0	60.3	80	63	92	
138C2	Clarion loam, 6 to 10 percent slopes, moderately eroded	4.02	20.2%		IIle	204.8	59.4	83	63	73	
62D2	Storden loam, 10 to 16 percent slopes, moderately eroded	3.05	15.4%		IVe	140.8	40.8	41	41	66	
62E2	Storden loam, 10 to 22 percent slopes, moderately eroded	2.02	10.2%		IVe	116.8	33.9	32	31	60	
138D2	Clarion loam, 9 to 14 percent slopes, moderately eroded	1.86	9.4%		IIle	164.8	47.8	57	54	73	
138B	Clarion loam, 2 to 6 percent slopes	1.51	7.6%		Ile	225.6	65.4	89	80	84	
135	Coland clay loam, 0 to 2 percent slopes, occasionally flooded	0.17	0.9%		IIw	198.4	57.5	76	78	83	
<b>Weighted Average</b>						<b>2.81</b>	<b>185</b>	<b>53.6</b>	<b>68.2</b>	<b>56.9</b>	<b>*n 78.4</b>

\*\*IA has updated the CSR values for each county to CSR2.

\*i Yield data provided by the ISPAID Database version 8.1.1 developed by IA State University.

\*n: The aggregation method is "Weighted Average using all components"

\*c: Using Capabilities Class Dominant Condition Aggregation Method

Soils data provided by USDA and NRCS.