

Soils Map

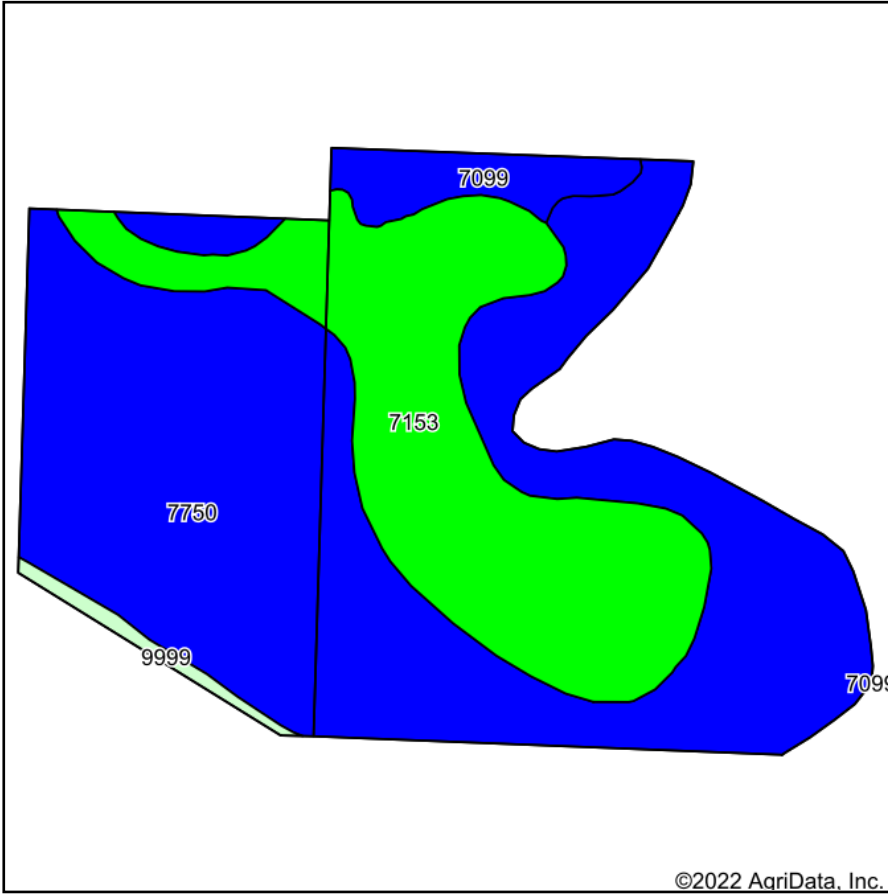

Soils data provided by USDA and NRCS.

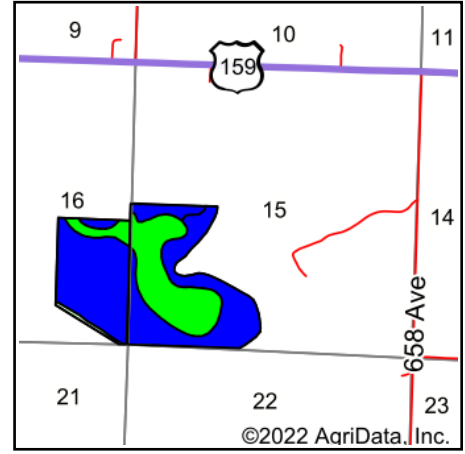

State: **Nebraska**
 County: **Richardson**
 Location: **15-1N-17E**
 Township: **Jefferson**
 Acres: **166.45**
 Date: **9/29/2022**



Maps Provided By:



© AgriData, Inc. 2021

www.AgriDataInc.com



Area Symbol: NE147, Soil Area Version: 20								
Code	Soil Description	Acres	Percent of field	Non-Irr Class Legend	Non-Irr Class *c	Irr Class *c	*n NCCPI Overall	
7750	Nodaway silt loam, occasionally flooded	105.29	63.3%		Ilw	Ilw	94	
7153	Kennebec silt loam, rarely flooded	50.02	30.1%		lw		89	
7099	Zook silty clay loam, occasionally flooded	9.25	5.6%		Ilw	Ilw	66	
9999	Water	1.89	1.1%					
Weighted Average						*-	*-	*n 89.9

*n: The aggregation method is "Weighted Average using all components"

*c: Using Capabilities Class Dominant Condition Aggregation Method

*- Non Irr Class weighted average cannot be calculated on the current soils data due to missing data.

*- Irr Class weighted average cannot be calculated on the current soils data due to missing data.

Soils data provided by USDA and NRCS.