

Soils Map

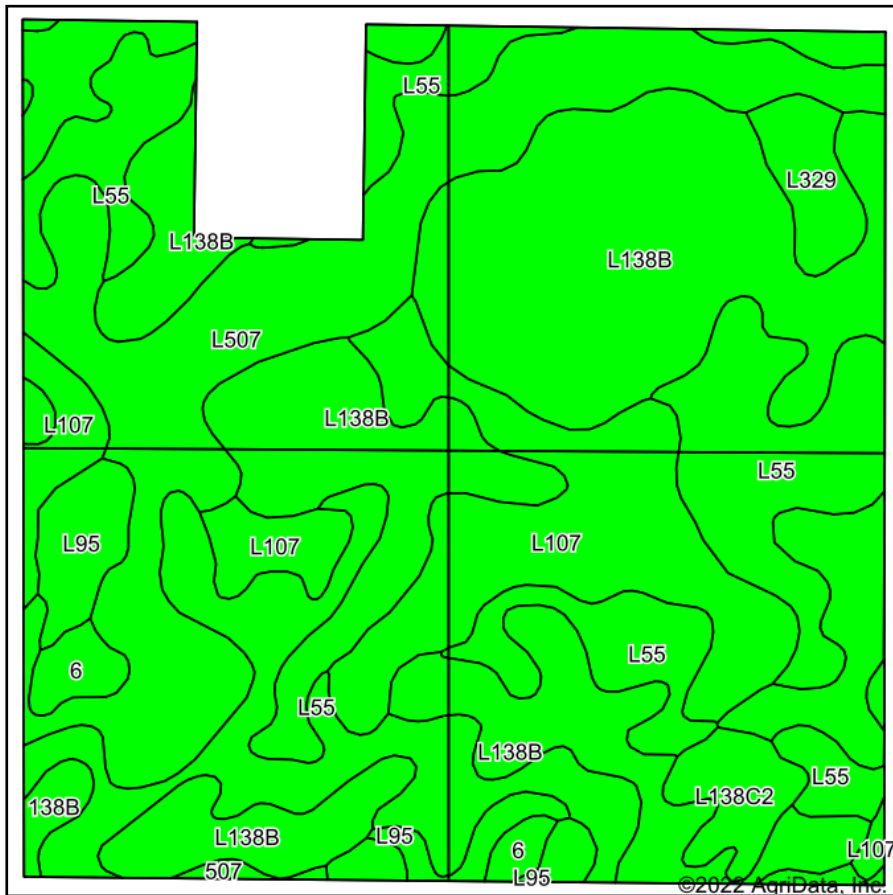

Soils data provided by USDA and NRCS.

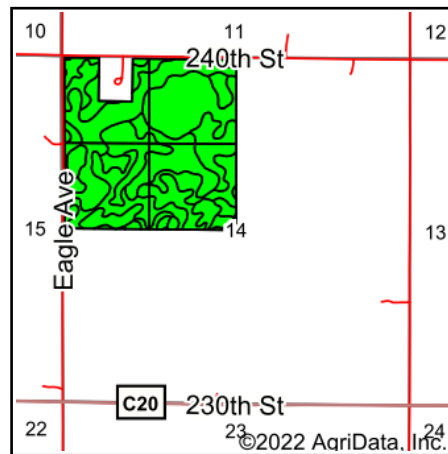

State: **Iowa**
 County: **Franklin**
 Location: **14-93N-22W**
 Township: **Wisner**
 Acres: **149.32**
 Date: **8/9/2022**



Maps Provided By:



Area Symbol: IA069, Soil Area Version: 28

Code	Soil Description	Acres	Percent of field	CSR2 Legend	Non-Irr Class *c	*i Corn Bu	*i Soybeans Bu	CSR2**	CSR	*n NCCPI Overall
L138B	Clarion loam, Bemis moraine, 2 to 6 percent slopes	56.76	38.0%		Ile	220.8	64.0	88		80
L55	Nicollet loam, 1 to 3 percent slopes	35.03	23.5%		Ie	0.0	0.0	91		85
L507	Canisteo clay loam, Bemis moraine, 0 to 2 percent slopes	25.52	17.1%		IIw	0.0	0.0	87		81
L107	Webster clay loam, Bemis moraine, 0 to 2 percent slopes	19.23	12.9%		IIw	0.0	0.0	88		84
L95	Harps clay loam, Bemis moraine, 0 to 2 percent slopes	3.80	2.5%		IIw	0.0	0.0	75		80
L138C2	Clarion loam, Bemis moraine, 6 to 10 percent slopes, moderately eroded	2.70	1.8%		IIIe	0.0	0.0	83		67
L329	Webster-Nicollet complex, Bemis moraine, 0 to 3 percent slopes	2.60	1.7%		IIw	0.0	0.0	89		84
6	Okoboji silty clay loam, 0 to 1 percent slopes	2.41	1.6%		IIIw	164.8	47.8	59	57	76
138B	Clarion loam, 2 to 6 percent slopes	0.93	0.6%		Ile	225.6	65.4	89	82	84
507	Canisteo clay loam, 0 to 2 percent slopes	0.34	0.2%		IIw	224.0	65.0	84	79	81
Weighted Average						1.80	88.5	25.7	87.7	*- *n 81.7

**IA has updated the CSR values for each county to CSR2.

*- CSR weighted average cannot be calculated on the current soils data, use prior data version for csr values.

*i Yield data provided by the ISPAID Database version 8.1.1 developed by IA State University.

*n: The aggregation method is "Weighted Average using all components"

*c: Using Capabilities Class Dominant Condition Aggregation Method

Soils data provided by USDA and NRCS.