

Soils Map

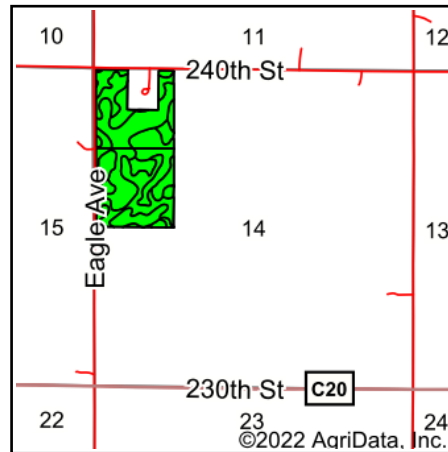

State: **Iowa**
 County: **Franklin**
 Location: **14-93N-22W**
 Township: **Wisner**
 Acres: **69.88**
 Date: **8/22/2022**

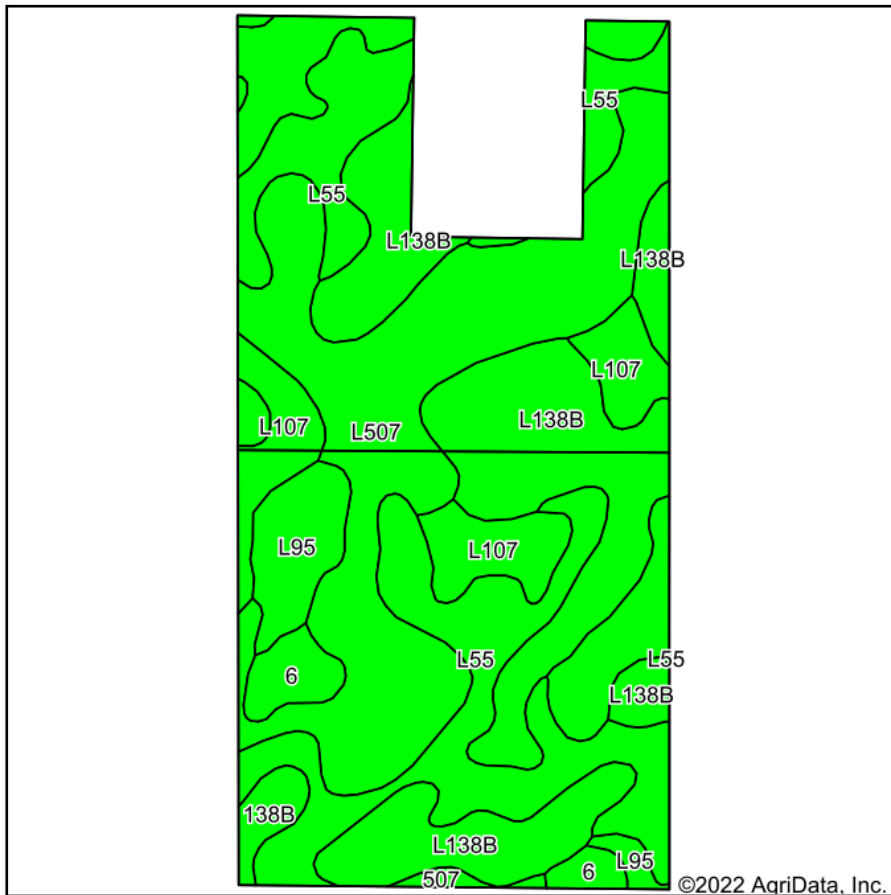

Maps Provided By:



Soils data provided by USDA and NRCS.

Area Symbol: IA069, Soil Area Version: 28

Code	Soil Description	Acres	Percent of field	CSR2 Legend	Non-Irr Class *c	*i Corn Bu	*i Soybeans Bu	CSR2**	CSR	*n NCCPI Overall
L138B	Clarion loam, Bemis moraine, 2 to 6 percent slopes	21.45	30.7%		Ile	220.8	64.0	88		80
L507	Canisteo clay loam, Bemis moraine, 0 to 2 percent slopes	18.99	27.2%		IIw	0.0	0.0	87		81
L55	Nicollet loam, 1 to 3 percent slopes	15.45	22.1%		Ie	0.0	0.0	91		85
L107	Webster clay loam, Bemis moraine, 0 to 2 percent slopes	7.96	11.4%		IIw	0.0	0.0	88		84
L95	Harps clay loam, Bemis moraine, 0 to 2 percent slopes	2.97	4.3%		IIw	0.0	0.0	75		80
6	Okoboji silty clay loam, 0 to 1 percent slopes	1.79	2.6%		IIIw	164.8	47.8	59	57	76
138B	Clarion loam, 2 to 6 percent slopes	0.93	1.3%		Ile	225.6	65.4	89	82	84
507	Canisteo clay loam, 0 to 2 percent slopes	0.34	0.5%		IIw	224.0	65.0	84	79	81
Weighted Average						1.80	76.1	22.1	87.1	*- *n 81.8

**IA has updated the CSR values for each county to CSR2.

*- CSR weighted average cannot be calculated on the current soils data, use prior data version for csr values.

*i Yield data provided by the ISPAID Database version 8.1.1 developed by IA State University.

*n: The aggregation method is "Weighted Average using all components"

*c: Using Capabilities Class Dominant Condition Aggregation Method

Soils data provided by USDA and NRCS.